



On-Site Lake Evaluation Record

Lake Name: Pine Lake

County: Barry

State: MI

Evaluated by: Nate Karsten

Date: 5/29/14

Evaluations Performed

Aquatic Vegetation Evaluation

- Aquatic vegetation survey
- Aquatic vegetation brief check

Vegetation evaluation methods

- Visual evaluation
- Sample collection with rake
- Sonar profiling
- GPS-mapped sample locations

- Water quality sampling
 - On-site (Temperature, DO, Secchi disk)
 - Water samples collected for _____ analysis

- GPS data collection
 - Depth survey
 - Shoreline mapping
 - Reference point location
- Other _____

Overall Condition of Lake

- excellent (no problems or developing problems noted)
- very good (no immediate action required)
- fair (management required soon)
- poor (management needed as soon as possible)
- very poor (management action past due—IMMEDIATE response required)

Problems Noted

- Excessive growth of exotic plants (mark locations on map)
 - Eurasian watermilfoil
 - curlyleaf pondweed
 - other _____
- Excessive growth of native plants (note plant species and mark locations on map)
- Excessive filamentous algae growth (mark location on map)
- Poor water clarity
- Blue-green algal blooms

RECOMMENDATIONS

- X Herbicide application (mark locations on map)
Need for herbicide treatments is: urgent, x serious, moderate, slight

- Algaecide application (mark locations on map)
Need for algae treatments is: urgent, serious, moderate, x slight

- Harvesting (mark locations on map)
Need for harvesting is: urgent, serious, moderate, slight

- Shoreline stabilization (mark locations on map)
Need for shoreline stabilization is: urgent, serious, moderate, slight

- Erosion control (mark locations on map)
Need for erosion control is: urgent, serious, moderate, slight

- Other _____

NOTES

The overall condition of Pine Lake is very good. Following the 2013 whole lake treatment, Eurasian watermilfoil levels are down significantly. The goal for 2014 will be to identify any areas of milfoil re-growth and address them as needed on an isolated, spot treatment basis. During the May, 29 2014 survey, a few isolated areas of milfoil/curlyleaf pondweed (also exotic) were found (see map). We recommend that these specific areas be maintain milfoil at low levels and reduce its abundance on the lake.

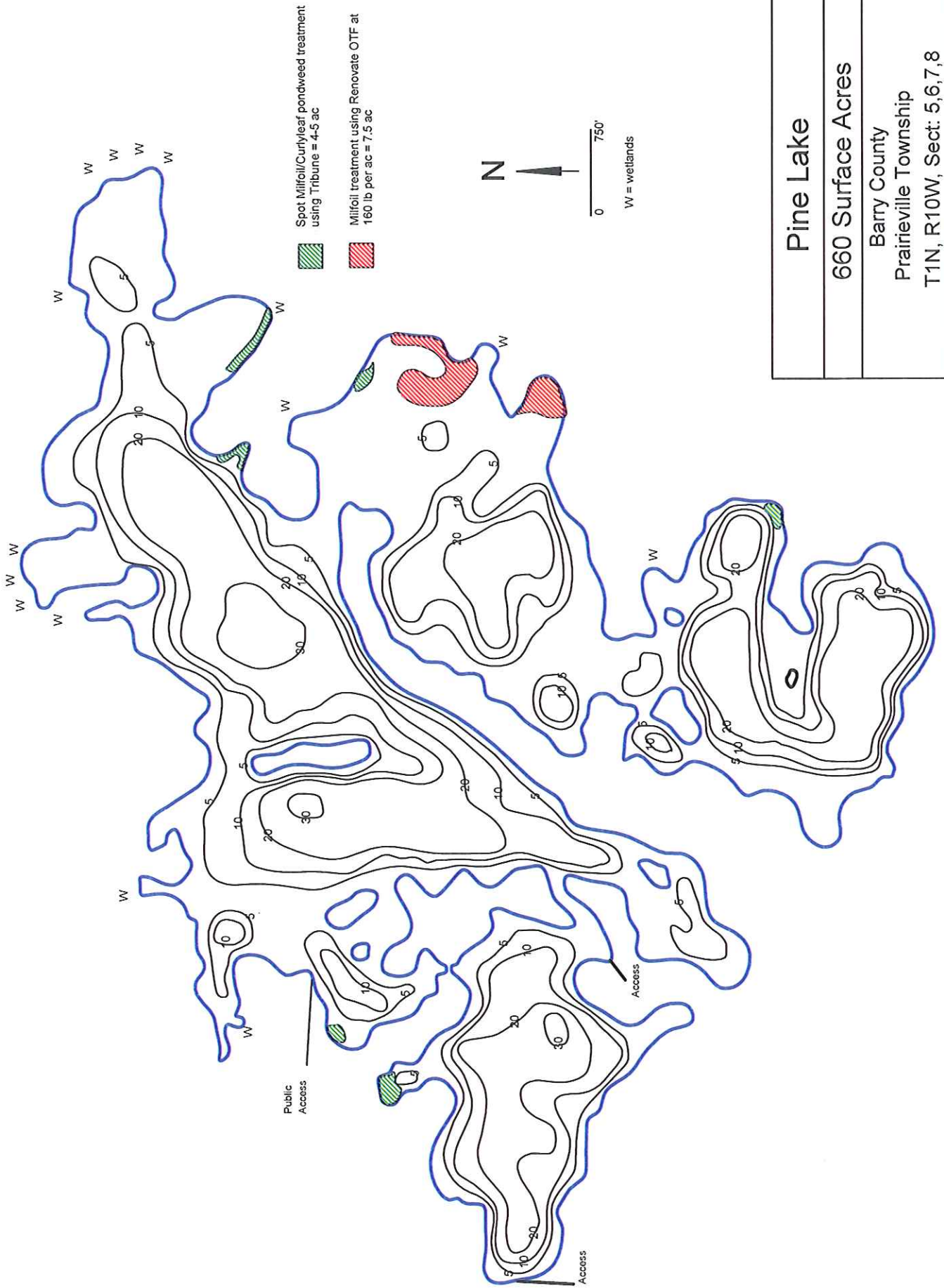

Pine Lake
660 Surface Acres
Barry County
Prairieville Township
T1N, R10W, Sect: 5,6,7,8
Professional Lake Management, P.O. Box 132, Caledonia, MI 48316 Phone (601) 382-4434